

The CareAttend App

Creating a Passcode

To use the CareAttend app, you need to create a Passcode

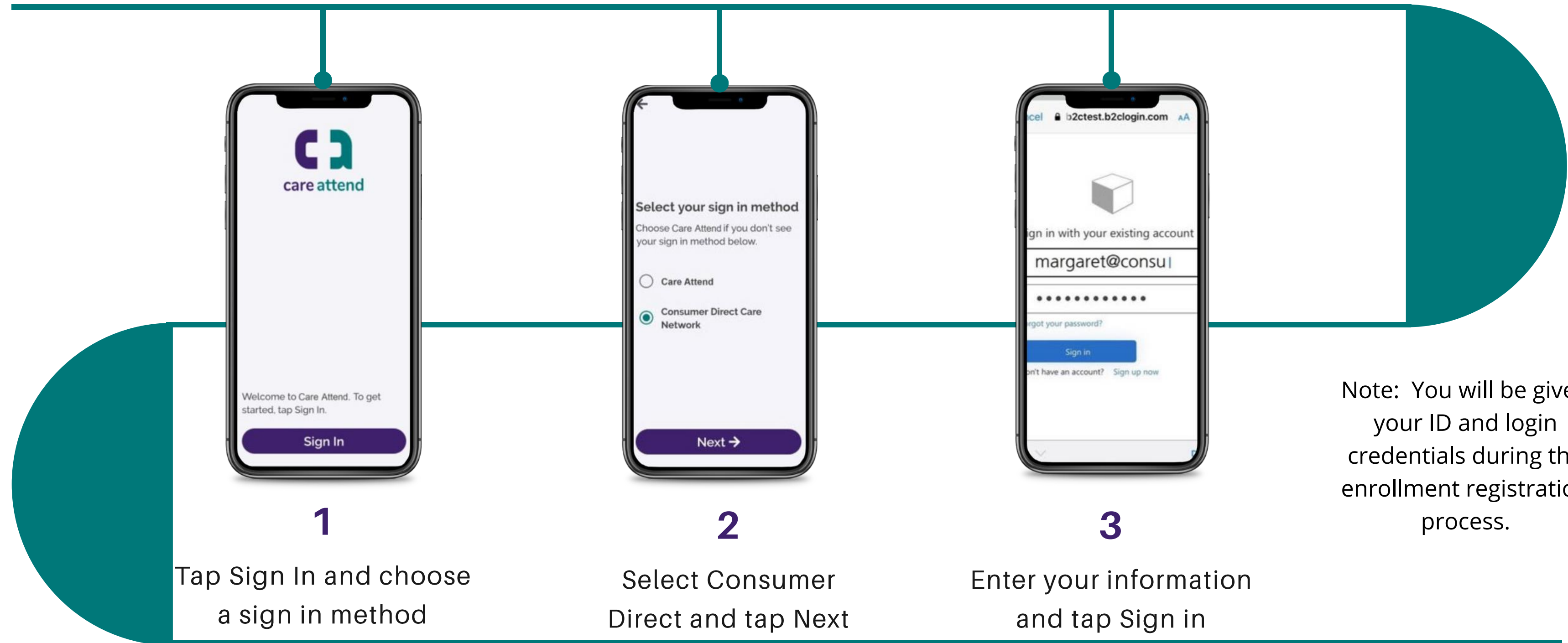

Note: You will be given your ID and login credentials during the enrollment registration process.

The CareAttend App

Creating a Passcode

Sign up to a CareAttend account

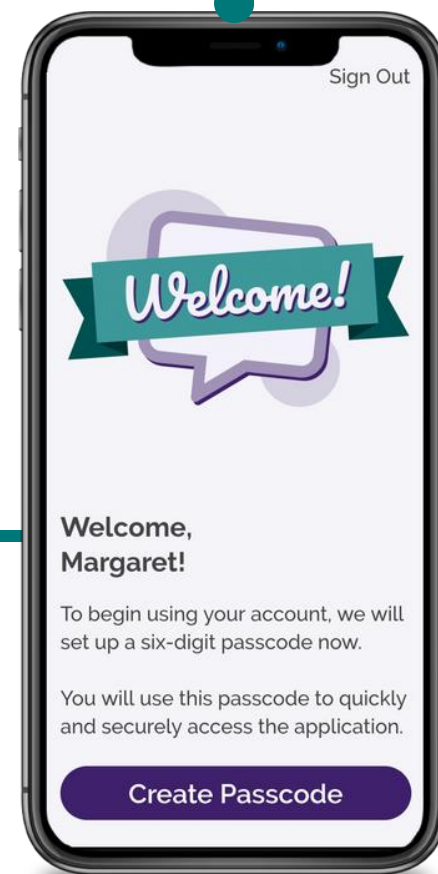

4

Tap Create Passcode

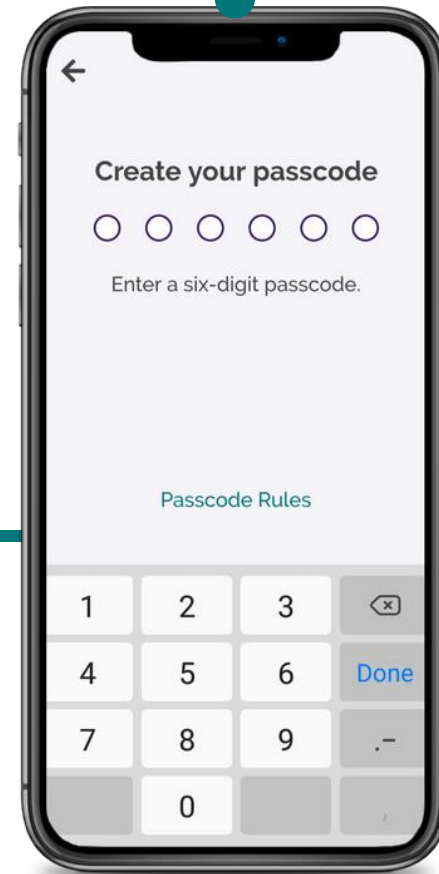

5

Choose a six-digit passcode that meets the requirements

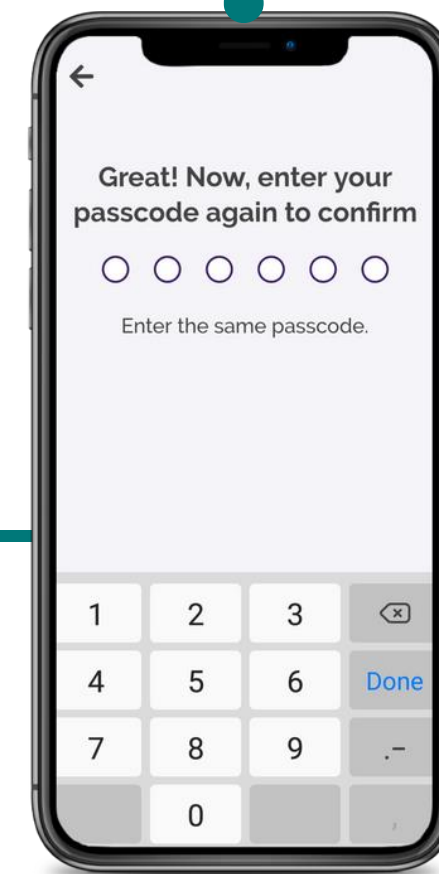

6

Enter and Confirm your passcode



7

You can now sign in with your Passcode